

**圖例**  
**LEGEND:**

- 施工區界限  
LIMIT OF WORKS AREA
- 擬建車道  
PROPOSED CARRIAGEWAY
- 擬建行人路  
PROPOSED FOOTPATH
- 現有車道將永久封閉並改建為行人路  
EXISTING CARRIAGEWAY TO BE PERMANENTLY CLOSED AND CONVERTED INTO FOOTPATH
- 現有行人路將永久封閉並改建為車道  
EXISTING FOOTPATH TO BE PERMANENTLY CLOSED AND CONVERTED INTO CARRIAGEWAY
- 現有車道將暫時封閉及重建  
EXISTING CARRIAGEWAY TO BE TEMPORARILY CLOSED AND RECONSTRUCTED
- 現有行人路將暫時封閉及重建  
EXISTING FOOTPATH TO BE TEMPORARILY CLOSED AND RECONSTRUCTED
- 行車線 (每一個箭頭代表一條行車線)  
TRAFFIC LANE (ONE ARROW REPRESENTS ONE LANE)

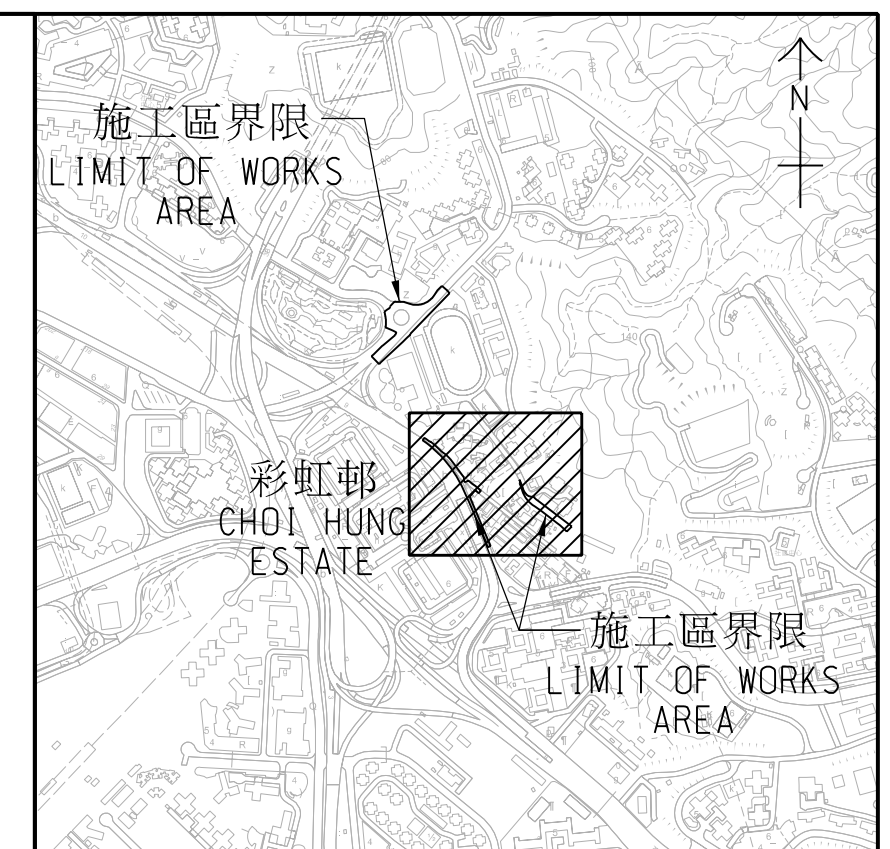

**索引圖**  
**KEY PLAN**  
比例 SCALE  
AT 1 : 15000

**註釋**  
**NOTES:**

- 除另有指明外，所有量度以米為單位。  
ALL DIMENSIONS ARE IN METRES UNLESS OTHERWISE SPECIFIED.
- 所有水平均為約數，以米為單位，並基於香港主水平基準上。  
ALL LEVELS ARE APPROXIMATE VALUES AND IN METRES ABOVE HONG KONG PRINCIPAL DATUM.
- 如有需要，施工區界限內部分現有行車道及行人路或會分階段暫時封閉。  
SECTIONS OF THE EXISTING CARRIAGEWAYS AND FOOTPATHS WITHIN THE LIMIT OF WORKS AREA MAY BE TEMPORARILY CLOSED IN PHASES AS AND WHEN REQUIRED.

批簽 ENDORSED BY

陳美寶 CHAN Mable  
運輸及物流局常任秘書長  
PERMANENT SECRETARY FOR  
TRANSPORT AND LOGISTICS

日期 DATE :

核准 APPROVED BY

楊創德 C.T. YEUNG  
總工程師/南1  
土木工程拓展署  
CHIEF ENGINEER / SOUTH 1  
CIVIL ENGINEERING AND DEVELOPMENT DEPARTMENT

日期 DATE :

工程名稱 PROJECT TITLE

工務計劃項目第7870CL號  
黃大仙牛池灣村公營房屋發展之  
地平整及基礎設施工程的道路工程  
ROAD WORKS UNDER PWP ITEM NO. 7870CL  
SITE FORMATION AND INFRASTRUCTURE WORKS  
FOR PUBLIC HOUSING DEVELOPMENT AT NGAU  
CHI WAN VILLAGE, WONG TAI SIN

圖則名稱 PLAN TITLE

根據《道路(工程、使用及補償)條例》  
(第370章)而在憲報公布之圖則  
PLAN FOR GAZETTING UNDER ROADS  
(WORKS, USE AND COMPENSATION)  
ORDINANCE (CHAPTER 370)

二張之第一張  
SHEET 1 OF 2

圖則編號 PLAN NO.

60688473/GAZ/101

比例 SCALE  
AT 1 : 500

辦事處 OFFICE

南拓展處  
SOUTH DEVELOPMENT OFFICE



插圖 A  
INSET A  
比例 SCALE  
AT 1 : 200

插圖 A  
INSET A

牛池灣村  
NGAU CHI WAN  
VILLAGE

彩虹邨  
CHOI HUNG  
ESTATE

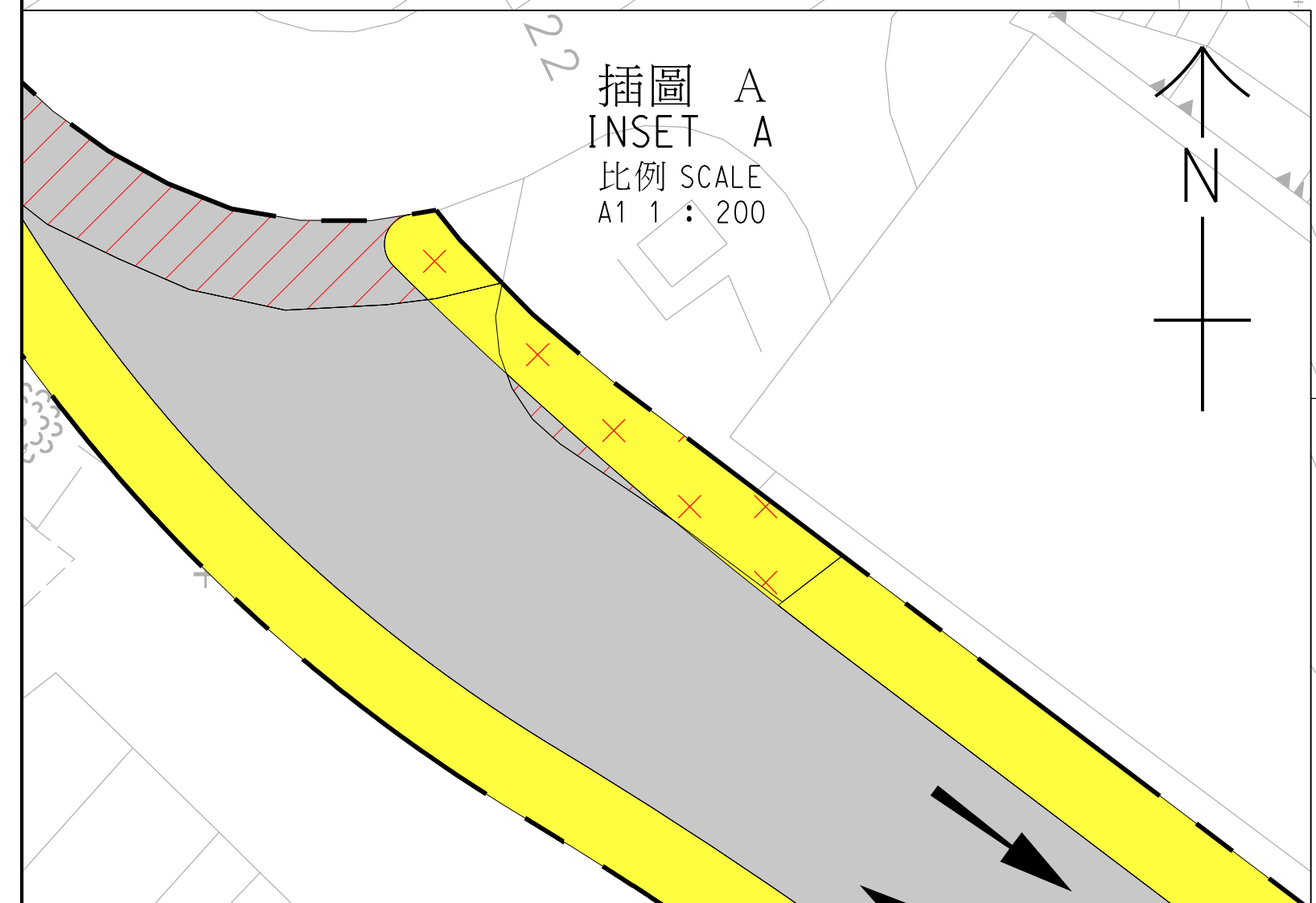

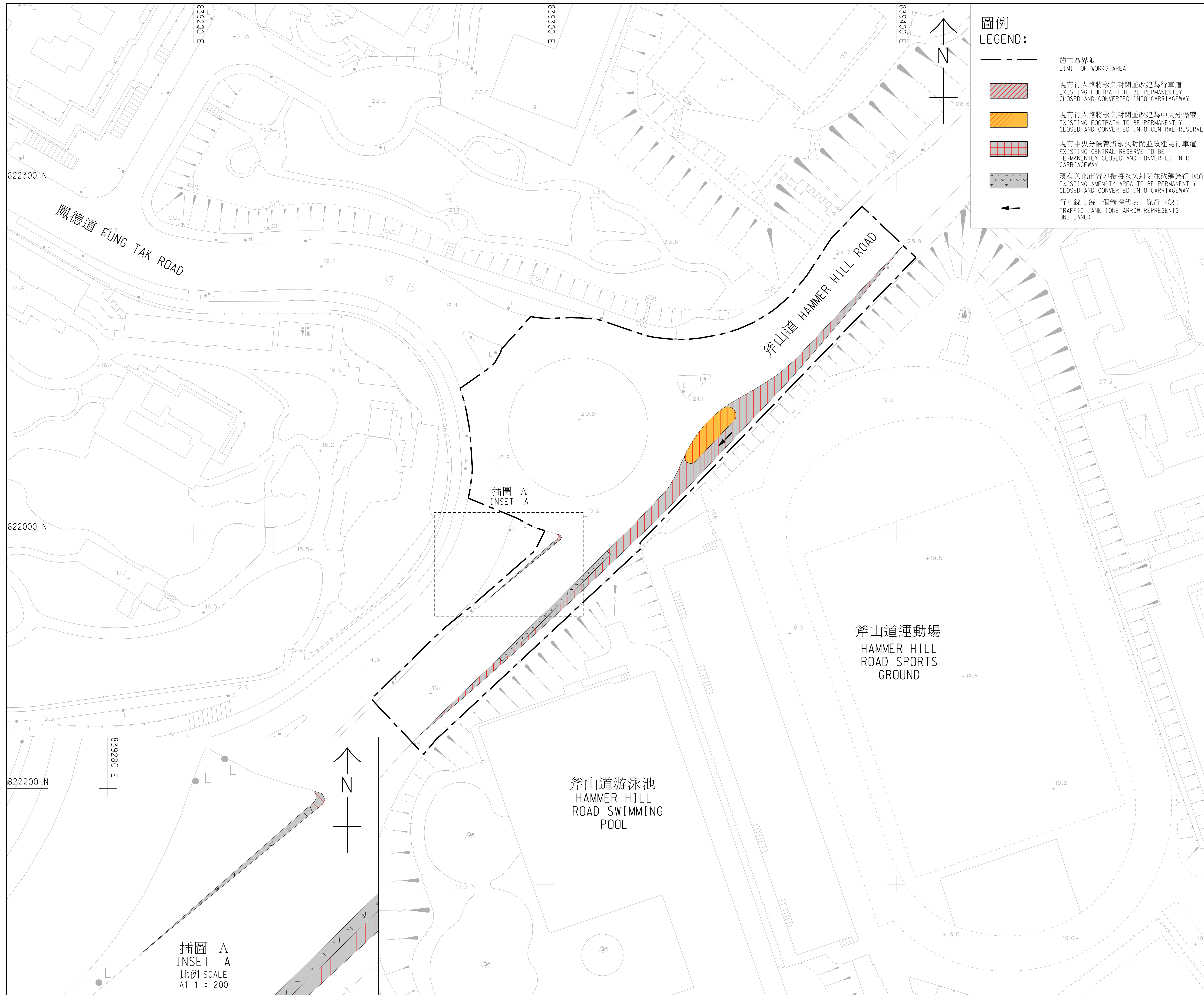

龍池徑  
LUNG CHI PATH

永定道  
WING TING ROAD

龍翔道  
LUNG CHEUNG ROAD

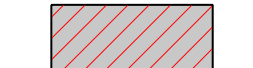

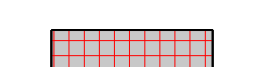
圖例  
LEGEND:

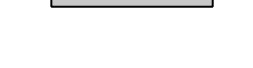
-  施工區界限  
LIMIT OF WORKS AREA
-  現有行人路將永久封閉並改建為行車道  
EXISTING FOOTPATH TO BE PERMANENTLY CLOSED AND CONVERTED INTO CARRIAGEWAY
-  現有行人路將永久封閉並改建為中央分隔帶  
EXISTING FOOTPATH TO BE PERMANENTLY CLOSED AND CONVERTED INTO CENTRAL RESERVE
-  現有中央分隔帶將永久封閉並改建為行車道  
EXISTING CENTRAL RESERVE TO BE PERMANENTLY CLOSED AND CONVERTED INTO CARRIAGEWAY
-  現有美化市容地帶將永久封閉並改建為行車道  
EXISTING AMENITY AREA TO BE PERMANENTLY CLOSED AND CONVERTED INTO CARRIAGEWAY
-  行車線 (每一個箭嘴代表一條行車線)  
TRAFFIC LANE (ONE ARROW REPRESENTS ONE LANE)

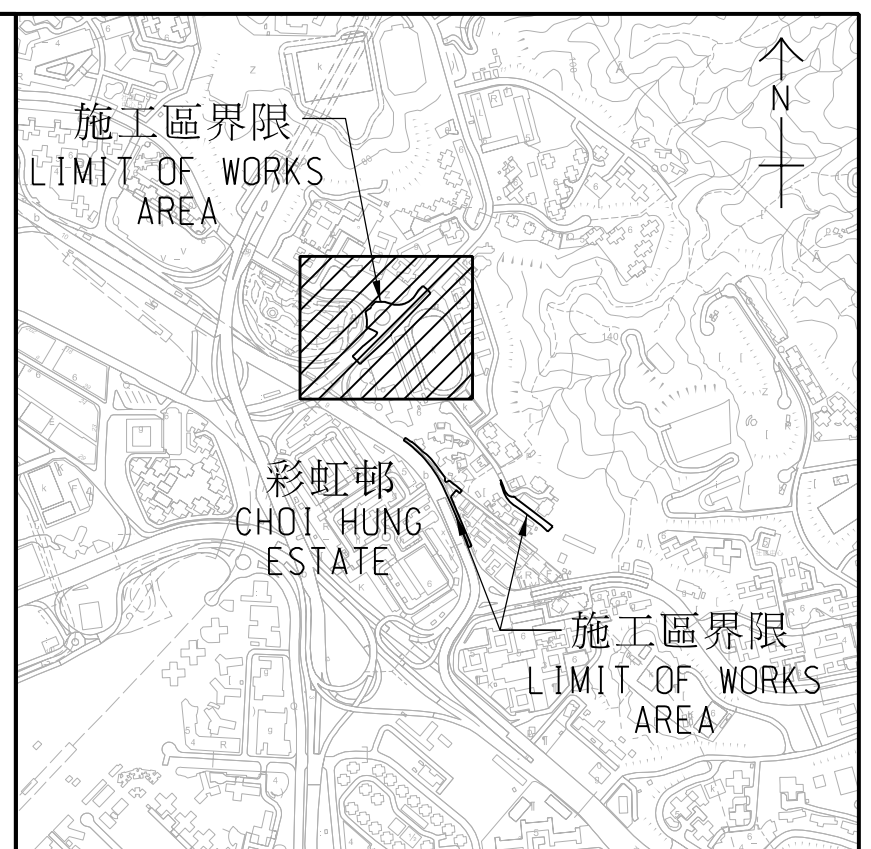

索引圖  
KEY PLAN

比例 SCALE  
AT 1 : 15000

註釋  
NOTES:

1. 除另有指明外，所有量度以米為單位。  
ALL DIMENSIONS ARE IN METRES UNLESS OTHERWISE SPECIFIED.
2. 所有水平均為約數，以米為單位，並基於香港主水平基準上。  
ALL LEVELS ARE APPROXIMATE VALUES AND IN METRES ABOVE HONG KONG PRINCIPAL DATUM.
3. 如有需要，施工區界限內部分現有行車道及行人路或會分階段暫時封閉。  
SECTIONS OF THE EXISTING CARRIAGEWAYS AND FOOTPATHS WITHIN THE LIMIT OF WORKS AREA MAY BE TEMPORARILY CLOSED IN PHASES AS AND WHEN REQUIRED.

批簽 ENDORSED BY

陳美寶 CHAN Mable

運輸及物流局常任秘書長  
PERMANENT SECRETARY FOR  
TRANSPORT AND LOGISTICS

日期 DATE :

核准 APPROVED BY

楊創德 C.T. YEUNG

總工程師/南1  
土木工程拓展署  
CHIEF ENGINEER / SOUTH 1  
CIVIL ENGINEERING AND DEVELOPMENT DEPARTMENT

日期 DATE :

工程名稱 PROJECT TITLE

工務計劃項目第7870CL號  
黃大仙牛池灣村公營房屋發展之  
工地平整及基礎設施工程的道路工程  
ROAD WORKS UNDER PWP ITEM NO. 7870CL  
SITE FORMATION AND INFRASTRUCTURE WORKS  
FOR PUBLIC HOUSING DEVELOPMENT AT NGAU  
CHI WAN VILLAGE, WONG TAI SIN

圖則名稱 PLAN TITLE

根據《道路(工程、使用及補償)條例》  
(第370章)而在憲報公布之圖則  
PLAN FOR GAZETTING UNDER ROADS  
(WORKS, USE AND COMPENSATION)  
ORDINANCE (CHAPTER 370)

二張之第二張  
SHEET 2 OF 2

圖則編號 PLAN NO.  
60688473/GAZ/102

比例 SCALE  
AT 1 : 500

辦事處 OFFICE

南拓展處  
SOUTH DEVELOPMENT OFFICE

